

Gravity Chair



INDOOR SEATING

Distributed by **medifab**[®]

SCRIPTING AND ORDERING GUIDE

Client Details

Client/User Name:		Notes
Date:		
NDIS/Funding:		

Size Options



Measurements	Small	Medium	Large	X-Large	User's Measurements
Code	3770-00X1-XXX	3770-00X2-XXX	3770-00X3-XXX	3770-00X4-XXX	
A Seat Depth	26cm 10.24"	32cm 12.6"	40cm 15.75"	45cm 17.72"	
B Seat Width at Back	20cm 7.87"	23cm 9.1"	27cm 10.63"	30cm 11.81"	
C Seat Width at Front	27cm 10.63"	30.5cm 12"	37cm 14.56"	40cm 15.75"	
D Back Height	60cm 23.62"	69cm 27.17"	74cm 29.13"	80cm 31.5"	
E Seat Front Height	20cm 7.87"	23cm 9"	26cm 10.24"	29cm 11.42"	
F Arm Support Height	29cm 11.42"	35cm 13.78"	39cm 15.35"	43cm 16.93"	
G Total Width of Chair	46cm 18.11"	49cm 19.29"	57cm 22.44"	60cm 23.62"	
H Total Height of Chair	55cm 21.65"	61cm 24"	66cm 25.98"	71cm 27.95"	
I Total Depth of Chair	60cm 23.62"	71cm 28"	82.5cm 32.48"	91cm 35.83"	
J Tilt Wedge Length	47cm 18.5"	57cm 22.44"	67cm 26.38"	74cm 29.13"	
K Tilt Wedge Height	10cm 3.94"	12cm 4.72"	14cm 5.51"	17cm 6.69"	
Weight Limit	50kg 110lb	70kg 154lb	100kg 220lb	130kg 278lb	

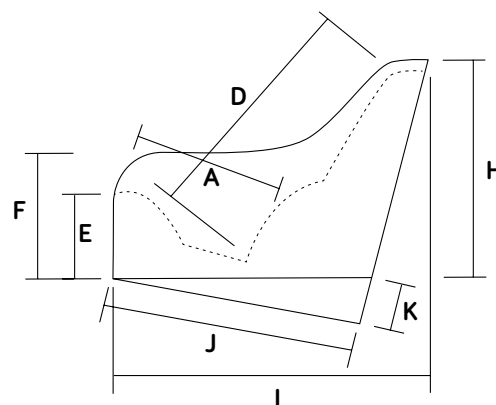
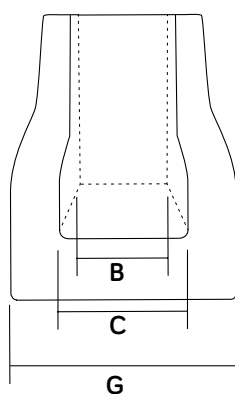

Gravity Chair Package includes:

- Foam chair with cover
- Coloured liner
- Standard head support
- Tilt wedge
- Velcro side pocket

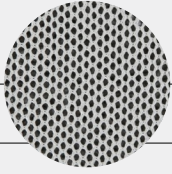

Cover/Liner Options

Classic Version <input type="checkbox"/>	Wipe Down Liner <input type="checkbox"/>
Air breathable fabric on the user contact surfaces and rear back panel, with wipe-down covers in all other areas	Fully wipe-down, including internal contact surfaces where user is seated
3770-001X-XXX 	3770-002X-XXX 

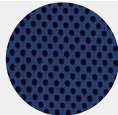
Red Liner <input type="checkbox"/>	Green Liner <input type="checkbox"/>	Blue Liner <input type="checkbox"/>
3770-00XX-022 	3770-00XX-055 	3770-00XX-066 

Head Supports

Occipital Head Support	Standard Lateral Head Support	Extended Lateral Head Support
Black Spacer Fabric <input type="checkbox"/> 	Black Spacer Fabric <input type="checkbox"/> 	Black Spacer Fabric <input type="checkbox"/> 
Spextex Wipe-Down Fabric <input type="checkbox"/> 	Spextex Wipe-Down Fabric <input type="checkbox"/> 	Spextex Wipe-Down Fabric <input type="checkbox"/> 

Mobile Base

For ease of maneuverability in the home or classroom				
Size 1 <input type="checkbox"/>	Size 2 <input type="checkbox"/>	Size 3 <input type="checkbox"/>	Size 4 <input type="checkbox"/>	
3780-8701-000	3780-8702-000	3780-8703-000	3780-8704-000	

Tray Table

Encourages hand-to-eye coordination		
To fit Size Small and Medium <input type="checkbox"/>	To fit size Large and X-Large <input type="checkbox"/>	
3770-7101-000	3770-7102-000	